

POIE-8000CA

Color Powdered/Granulated Medicine Inspection Equipment



POIE-8000CA is equipped with four 8,000 pixel CMOS RGB line sensors with a resolution of 20 μm per pixel. It performs density difference feature extraction processing and line segment feature extraction processing, and can perform contamination inspection such as fine hair (ϕ 30 μm \times 3 mm or more) and fine foreign substances (ϕ 50 μm or more).



POIE-8000CA

Stable transport unit

The transport and inspection units consist of the simple structure.

① Stable supply and loading

The supply part employs the shutter structure for the stable powder supply. And the system performs the stable power loading and accurate inspection. The internal parts can be detached and attached simply for operators and it can contribute for easy cleaning.

② Powerful LED illumination

The 3-steps rotary nozzles structure can surely evacuate foreign materials and minimize to remove the accepted powders.

③ Spot evacuation by rotary nozzles

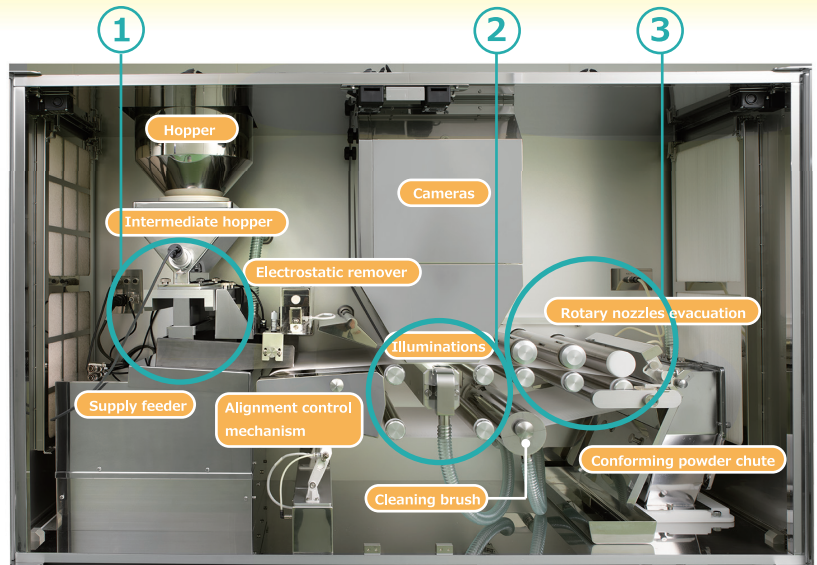

The powerful white color LED illumination can support the reliable detection of the foreign materials.



<Normal>

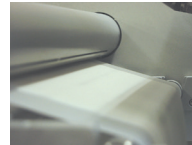

<Spot evacuation>



Transport unit outline

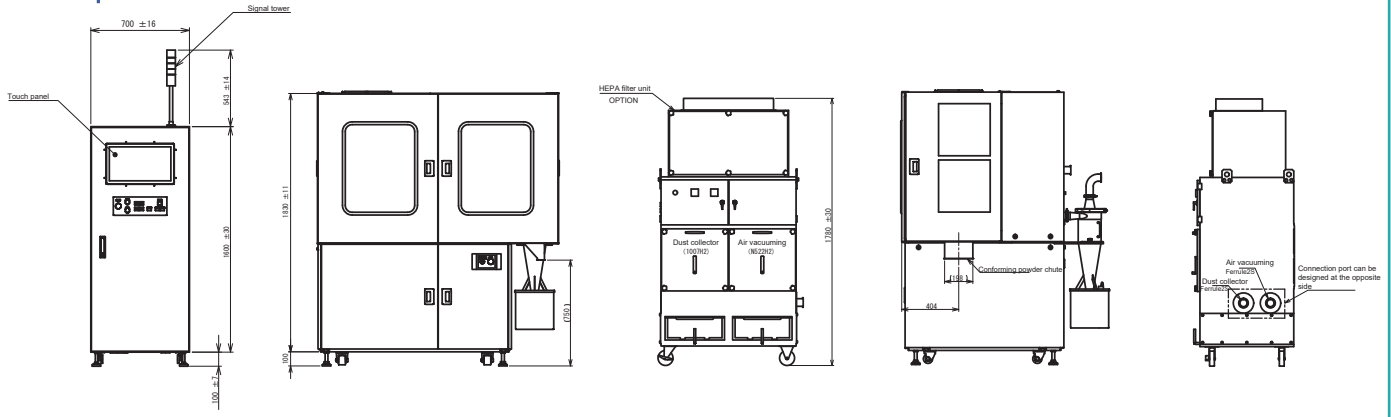

Applicable Particle	Powder, Fine Granule, Granule etc., Colored
Inspection Throughput	20~200kg/hour
Inspection Objects	Black or Colored Foreign Particle of over $\phi 50\mu\text{m}$ (diameter), Black or Colored Fiber and Hair of over $\phi 30\mu\text{m} \times 3\text{mm}$ (diameter). *Inspection accuracy depends on inspection throughput and object.
Transport Section	Transport belt: 1 row Transport Belt speed: Approx. 8-30m/minute(7 steps selectable) Inspection area: Approx. 400mm in width Transported particle thickness: Approx. 0.5-0.7mm(1 layer)
Camera Section	8000 pixel RGB CMOS sensor camera x 4 units Limit of resolution 20 μm
Lighting Section	Lighting source: 3x Line LED Lighting position: 2 spots at top, 1 spot at bottom Lamp system: Variable lighting level at 0-999 steps Lighting control: Auto control Expected lamp life: 30,000 hours

Power Source	Power supply: Three phase 200V \pm 10% 50/60Hz Power consumption: 6.5kW or less Connection: Terminal fixed with 6mm-screw
Air Pressured	Air Pressure: 0.5Mpa or more Consumption: 200NL/minute or less(clean dry air) Coupling socket size: Quick-connect air coupler socket 40SH
External Dimensions	Control unit: W570 x H1838 x D710mm Transport unit: W1708 x H1930 x D1149mm
Weight	Transport unit: Approx. 1,400kg(3,086 lbs) Control unit: Approx. 200kg(441 lbs) Air-vacuuming unit: Approx. 300kg(660 lbs)
Environment Condition	Temperature: 17-28 °C(63-82 °F) Humidity: 30~65%
Vacuumed Air Exhaust	Negative pressure: -21Kpa or more Exhaust air emission: 14cubic meter/minute
Dust collection discharge	Negative pressure: -8Kpa or more

Design and specifications are subject to change without notice.

U418B205-SELF

Ikegami Tsushinki Co.,Ltd.

■ URL : www.ikegami.co.jp/en/

■ Head Office : 5-6-16 Ikegami, Ohta-ku, Tokyo 146-8567, JapanTEL.+81-(0)3-5700-1111 / FAX.+81-(0)3-5700-1137

■ Inspection Solution Sales Department : 5-6-16 Ikegami, Ohta-ku, Tokyo 146-8567, JapanTEL.+81-(0)3-5748-2255 / FAX.+81-(0)3-5700-4120

■ Beijing Office : Tower A Room No.823-824 Jia Tai International Mansion No.41 East Fourth Ring Road, Chaoyang District, Beijing, China ...TEL / FAX.+86-(0)10-85710350

Ikegami Electronics (U.S.A.), INC.

■ URL : www.ikegami.com

■ Headquarters : 37 BROOK AVENUE, MAYWOOD, NJ 07607, U.S.A.TEL.+1-201-368-9171 / FAX.+1-201-569-1626

Ikegami Electronics (Europe) GmbH

■ URL : www.ikegami.de

■ Headquarters : Ikegami Strasse 1, D-41460 Neuss, Germany TEL.+49-(0)2131-1230 / FAX.+49-(0)2131-102820

Ikegami Electronics Asia Pacific Pte.Ltd.

■ URL : sg.ikegami.co.jp

■ Headquarters : 1 Tampines Central 5, #06-04 CPF Tampines Building, Singapore 529508TEL.+65-6260-8820 / FAX.+65-6260-8896

